

Appendix 2

ELECTRICAL - ALL NEW ELECTRICAL WORK IS DESIGNED, INSTALLED, INSPECTED AND TESTED IN ACCORDANCE WITH BS7671 (I.E.E. WIRING REGULATIONS: 18TH EDITION) THE WORKS ARE TO BE UNDERTAKEN BY AN INSTALLER REGISTERED UNDER A SUITABLE ELECTRICAL SELF-CERTIFICATION SCHEME, OR ALTERNATIVELY BY A SUITABLY QUALIFIED PERSON WITH A CERTIFICATE OF COMPLIANCE PRODUCED BY THAT PERSON TO BUILDING CONTROL ON COMPLETION OF THE WORKS.

EF15 DENOTES EXTRACT FAN GIVING 15LTS/SEC
EF30 DENOTES EXTRACT FAN GIVING 30LTS/SEC

⊕ DENOTES INTERCONNECTED, BATTERY BACKED SMOKE DETECTOR/ALARM ON SEPARATELY FUSED ELECTRIC CIRCUIT

ALL GLAZING IN CRITICAL AREAS TO BE SAFETY GLASS COMPLYING WITH BS 6206 1981.

- ⊕ EMERGENCY LIGHTING
- CO2 CO2 EXTINGUISHER
- W WATER EXTINGUISHER

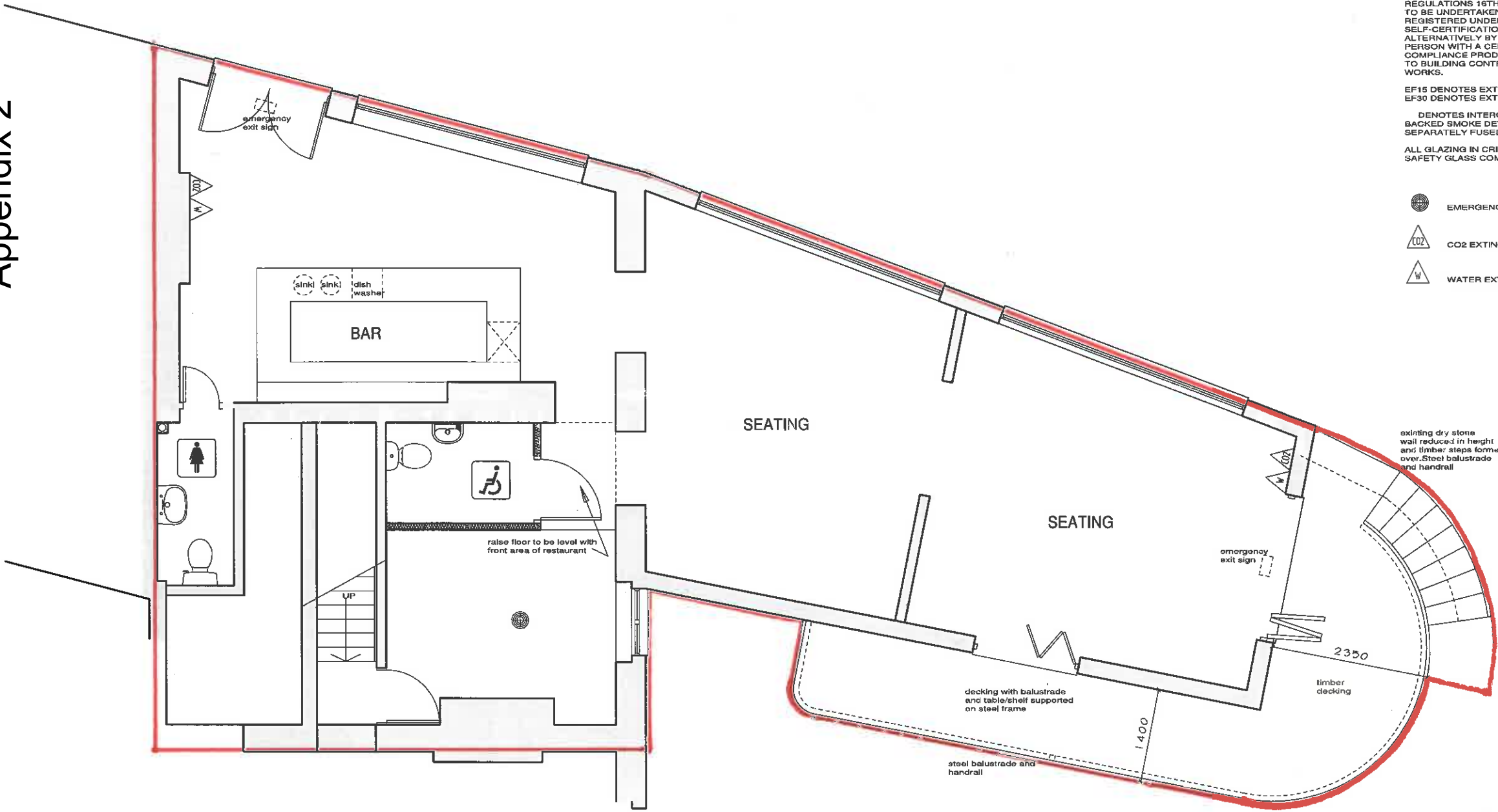

GROUND FLOOR

= licensable boundary