

meeting papers

Environment Committee

Thursday, 13 June 2013
7.00 pm



2002-2003
Crime Reduction in Rural Areas
2004-2005
Services for Older People
2007-2008
Emergency Planning



INVESTOR IN PEOPLE

FIRE EVACUATION PROCEDURES **FOR VISITORS AT EBLEY MILL**

- Upon hearing the fire alarm, visitors should immediately evacuate the building following the instructions given by the Chair at the start of each meeting.
- **DO NOT** stay, or return, to collect personal belongings.
- **DO NOT** use the lifts when the alarm is sounding.
- Upon evacuation, visitors should go to the NB assembly point. The assembly points are situated in the staff car park where a fire steward will be there to take a roll call.
- Visitors **must** remain at the assembly points until permission is given to leave.
- Visitors must **not** leave the site until instructed to do so.

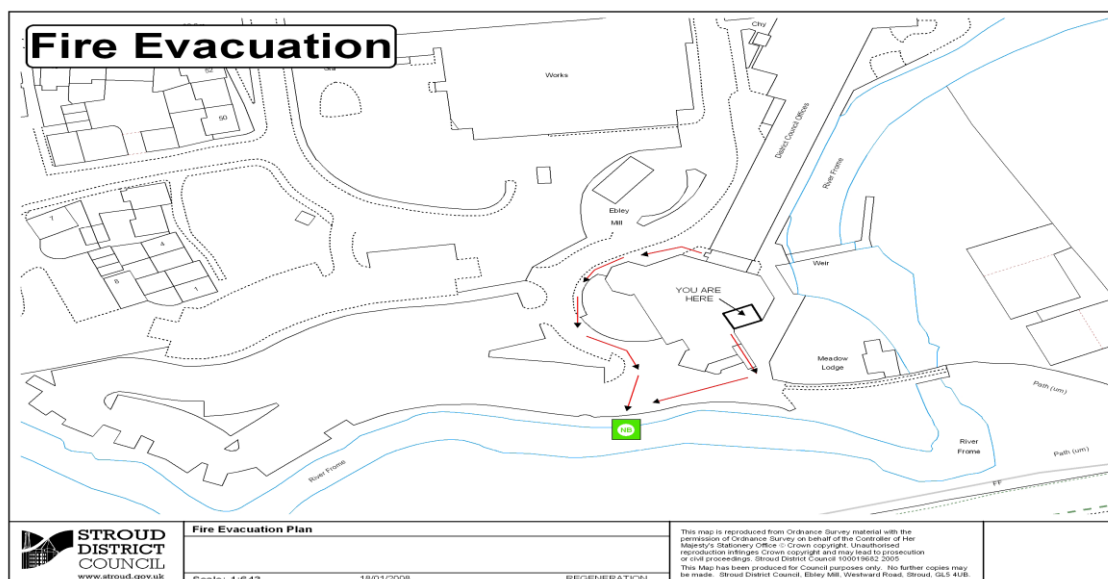

In the Event of a Fire

Leave the room by the nearest fire exit these are located to the rear of the Chamber and the door leading to the Roof Garden marked as Fire Exits. Proceed to the main car park and assemble by the New Build sign (NB).

For Agenda enquiries contact:	Judy Balfe, Democratic Services and Elections Officer Tel: 01453 754351 Email: judy.balfe@stroud.gov.uk
-------------------------------	--

31 May 2013

ENVIRONMENT COMMITTEE

A meeting of the Environment Committee will be held on **Thursday, 13 June 2013** in the Council Chamber, Ebley Mill, Ebley Wharf, Stroud at **7.00 pm.**



David Hagg
Chief Executive

AGENDA



Please Note: This meeting will be filmed for live or subsequent broadcast via the Council's internet site (www.stroud.gov.uk). The whole of the meeting will be filmed except where there are confidential or exempt items, which may need to be considered in the absence of the press and public.

The images and sound recording may be used for training purposes within the Council.

Whilst the public seating areas are not directly filmed, particular camera shots around the Chamber may capture persons seated in the public areas. If you ask a question in accordance with the procedures in the Council's Constitution and use a microphone for this purpose, then you will be deemed to have consented to being filmed. By entering the Council Chamber and using the public seating areas, you are consenting to being filmed and to the possible use of those images and sound recordings for webcasting and/or training purposes.

If you have any queries regarding the above, please contact the officer named at the top of this agenda.

1. **APOLOGIES**

2. **DECLARATIONS OF INTEREST**
To receive declarations of interest.

3. PUBLIC QUESTION TIME

The Chair of the Committee will answer questions from members of the public, submitted in accordance with the Council's procedures.

DEADLINE FOR RECEIPT OF QUESTIONS

Noon on Monday, 10 June 2013

Questions must be submitted in writing to the Chief Executive, Democratic Services, Ebley Mill, Ebley Wharf, Stroud and sent by post, by fax (01453 754957), or by Email: democratic.services@stroud.gov.uk

Indicative Timings

4. INTRODUCTION TO ENVIRONMENT COMMITTEE

To receive oral presentations on the service areas covered within Environment Committee

Presentations 35 minutes plus time for questions

5. ENVIRONMENT COMMITTEE BUDGETS

To inform the service committees of the services they are responsible for and the associated revenue budgets for 2013/14.

Presentation 5 minutes plus time for questions

6. APPOINTMENTS TO OUTSIDE BODIES

The new constitutional arrangements give responsibility to Committees to make appointments to outside bodies. A summary of the outside bodies relevant to this committee is attached. The Committee is asked to consider if an appointment to the body should be made and if it is, to then appoint a Councillor.

10 minutes

7. BUSINESS PLAN

To consider the Committee's business plan for 2013/14 and update accordingly.

5 minutes introduction plus time for discussion and suggestions from committee

8. MEMBERS' QUESTIONS

See Agenda Item 3 for deadline for submission.

DATE OF NEXT MEETING

Monday, 8 July 2013 (Special Meeting)

The Committee Membership for 2013/14 Civic Year is as follows:

Councillor Simon Pickering (Chair)

Councillor Paul Smith (Vice-Chair)

Councillor Liz Ashton

Councillor Paul Denney

Councillor Chas Fellows

Councillor Nick Hurst

Councillor Haydn Jones

Councillor Graham Littleton

Councillor Stephen Moore

Councillor Roger Sanders

Councillor Brian Tipper

Councillor Martin Whiteside

If you require this agenda in large print format please contact Democratic Services ☎ 01453 754351 or email: democratic.services@stroud.gov.uk

13 June 2013

5

Report Title	SERVICE COMMITTEE BUDGETS 2013/14
Purpose of Report	To inform the service committees of the services they are responsible for and the associated revenue budgets for 2013/14.
Decision(s)	The Committee RESOLVES to note the service budgets for which it is responsible.
Consultation and Feedback	The broad service areas that each committee is responsible for was discussed at a number of working groups prior to the final decision being made by Council on 16 May 2013. Consultation on the finer details of which cost centres sit with each committee has taken place with the Heads of Service and Corporate Team.
Financial Implications & Risk Assessment	There are no financial implications arising from this report. It is important that each committee is clear about each of the services and associated budgets it is responsible for to avoid delays in decision making. Sandra Cowley, Head of Finance Tel: 01453 754136 Email: sandra.cowley@stroud.gov.uk
Legal Implications	There are no significant legal implications arising from the report. Peter Woodcock, Legal Services Manager Tel 01453 754369 Email: peter.woodcock@stroud.gov.uk
Report Author	Sandra Cowley, Head of Finance Tel: 01453 754136 Email: sandra.cowley@stroud.gov.uk
Options	None.
Performance Management Follow Up	Regular budget monitoring reports will be presented to each committee throughout the year with the first report in the September cycle of meetings.
Background Papers and Appendices	Appendix A – Service Committees Revenue Budgets 2013/14

Background

1. The General Fund and Housing Revenue Account (HRA) budgets for 2013/14 were approved by Council at its meeting on 24th January 2013.
2. Traditionally, budgets have been presented to the Executive using the Chartered Institute of Public Finance and Accountancy's standard reporting format. The Statement of Accounts will continue to be reported in this format.
3. For 2013/14, a new reporting structure has been set up to enable each of the new service committees to see the budgets for each of the services it is responsible for. The details are shown in Appendix A.
4. The Housing Committee is responsible for budgets associated with the Council's housing stock which is essentially the Housing Revenue Account. As such, there will be no change to how the Housing budgets are presented.

Budget Monitoring and Reporting

5. The HRA Outturn 2012/13 will be presented to the Housing Services Committee on 20 June 2013. Both the General Fund and HRA Outturn for 2012/13 will be presented to the Strategy and Resources Committee at its meeting on 27 June. This is because this committee has overall responsibility for the Council's finances.
6. The first quarter performance against budget for 2013/14 will be presented to each of the Committees at their meetings in September. The second quarter will be presented in the October/November cycle of meetings.
7. Revised budgets for 2013/14 and draft budgets for 2014/15 will be presented to the committees in December. The Strategy and Resources Committee will receive the General Fund MTFP and will put forward a budget and level of council tax for Council to consider in January 2014. The Housing Services and Strategy & Resources committees will receive the HRA MTFP and rent levels to put forward to Council in January.

Service Committee Budgets 2013/14

8. Appendix A sets out the detailed budgets for the Community Services, Environment and Strategy & Resources committees for 2013/14. These three budgets make up the total General Fund revenue budget.
9. Only the support service budgets are shown gross in the first column. As they are fully recharged to all other services, they show as zero in the net budget. It has been presented like this so members can see the cost of the support services.
10. This is intended to give members the opportunity to become familiar with the service budgets they are responsible for and to ensure that all budgets have been allocated to the correct committee. There may be some minor amendments required but any significant changes to what is presented here should be put as a recommendation to the Strategy & Resources Committee at its meeting on 27 June 2013.

Services by Committee	Gross Budget £	Support Service Income £	Net Budget £	Budget Holder
Community Services Committee				
Community Safety				
Community Safety	237,000	0	237,000	P Sullivan
Neighbourhood Wardens	244,400	0	244,400	P Sullivan
Health and Wellbeing	39,000	0	39,000	P Sullivan
Hear by Right/Youth Services	94,500	0	94,500	P Sullivan
Careline Services	-12,300	0	-12,300	P Sullivan
Stroud and Dursley CCTV	43,300	0	43,300	P Sullivan
Car Parks - Enforcement (Off Street)	95,200	0	95,200	P Sullivan
Community Safety Total	741,100	0	741,100	
Community Services Management				
Strategic Head of Customer Services	131,800	-131,800	0	J Jordan
Cultural Services				
Head of Cultural Services	107,400	-107,400	0	R Figg
Arts & Culture	18,000	0	18,000	R Figg
Museum in the Park	453,100	0	453,100	K Ward
Subscription Rooms	287,700	0	287,700	P McLaughlin
Sport & Health Development	148,100	0	148,100	J Bullows
Joint Use Sports Centres	215,300	0	215,300	M Hammond
Dursley Pool	313,300	0	313,300	A Gillingham
Stratford Park Leisure Centre	606,400	0	606,400	M Hammond
Tourism	176,200	0	176,200	M Russell
Cultural Services Total	2,325,500	-107,400	2,218,100	
Customer Services				
Cashiers	67,900	-67,900	0	J Jordan
Customer Services Centre	409,100	-409,100	0	J Jordan
Customer Services Total	477,000	-477,000	0	
Grants to Voluntary Organisations				
Grants to Voluntary Organisations	354,600	0	354,600	J Jordan
Rural & Community Investment Scheme	39,000	0	39,000	J Jordan
Grants to Voluntary Organisations Total	393,600	0	393,600	
Housing (General Fund)				
Gardening Assistance Scheme	15,600	0	15,600	J Beckett
Housing Strategy	109,000	0	109,000	P Stroud
Housing Act Advances	4,900	0	4,900	P Stroud
Private Housing	299,500	0	299,500	J Beckett
Empty Homes Initiative	200	0	200	J Beckett
Homelessness	140,400	0	140,400	S Mace
Homelessness Prevention	169,600	0	169,600	S Mace
Housing (GF) Total	739,200	0	739,200	

Services by Committee	Gross Budget £	Support Service Income £	Net Budget £	Budget Holder
Public Spaces				
Commons and Woodlands	26,600	0	26,600	C Novoth
Amenity Areas	159,200	0	159,200	C Novoth
Stratford Park Grounds Maintenance	226,200	0	226,200	C Novoth
Stratford Court	7,300	0	7,300	C Novoth
Public Space Service	497,900	-497,900	0	C Novoth
Grassed Areas Contribution to HRA	170,600	0	170,600	K Topping
Public Spaces Total	1,087,800	-497,900	589,900	
Revenues & Benefits				
Council Tax Collection	504,100	0	504,100	J Jordan
Council Tax Support	169,000	0	169,000	J Jordan
Business Rate Collection	-68,900	0	-68,900	J Jordan
Discretionary NNDR Relief	53,600	0	53,600	J Jordan
Rent Allowances & Rebates	-22,800	0	-22,800	J Jordan
Housing Benefit Administration	379,700	0	379,700	J Jordan
Revenues & Benefits Total	1,014,700	0	1,014,700	
Community Services Committee Total	6,910,700	-1,214,100	5,696,600	
Environment Committee				
Canal				
Canal Restoration Project	87,000	0	87,000	I Edwards
Canal Partnership	32,100	0	32,100	I Edwards
Canal Total	119,100	0	119,100	
Carbon Management				
Environmental Strategy Co-ordination	50,500	0	50,500	B Wyatt
Energy Efficiency Contract (SWEA)	108,600	0	108,600	J Beckett
Climate Change (Planning & Policy)	-27,000	0	-27,000	B Wyatt
Energy Efficiency	93,200	0	93,200	J Beckett
Carbon Management Total	225,300	0	225,300	
Conservation				
Trees	48,800	0	48,800	P Skill
Conservation	74,700	0	74,700	P Skill
Conservation Total	123,500	0	123,500	
Environment - Management				
Strategic Head - Development Services	131,400	-131,400	0	B Wyatt
Head of Planning	74,400	-74,400	0	P Skill
Environment - Management Total	205,800	-205,800	0	

Services by Committee	Gross Budget £	Support Service Income £	Net Budget £	Budget Holder
Environmental Health				
Cemeteries	104,800	0	104,800	C Novoth
Head of Environmental Health	310,800	-310,800	0	J Beckett
Food Safety	193,700	0	193,700	J Beckett
Environmental Protection	229,800	0	229,800	J Beckett
Contaminated Land	37,900	0	37,900	J Beckett
Health and Safety	127,400	0	127,400	J Beckett
Port Health	16,100	0	16,100	J Beckett
Pest Control	109,200	0	109,200	J Beckett
Public Health	85,400	0	85,400	J Beckett
Dog Warden Service	120,400	0	120,400	J Beckett
Planning Liaison	-6,600	0	-6,600	J Beckett
Public Conveniences	398,300	0	398,300	C Novoth
Land Drainage	75,600	0	75,600	J Beckett
Abandoned Vehicles	15,000	0	15,000	P Sullivan
Environmental Health Total	1,817,800	-310,800	1,507,000	
Matters requiring member decisions				
Licensing	600	0	600	J Beckett
Footpaths	-1,400	0	-1,400	P Woodcock
Matters requiring member decisions Total	-800	0	-800	
Statutory Building Control				
Planning & Building Control Admin	253,500	-245,000	8,500	P Skill
Building Control	-31,200		-31,200	P Skill
Securing Dangerous Structures	21,900		21,900	P Skill
Building Regulation Enforcement / Advice	134,200		134,200	P Skill
Street Naming	1,300		1,300	P Skill
Development Control	329,300		329,300	P Skill
Appeals	75,500		75,500	P Skill
Enforcement	120,000		120,000	P Skill
Statutory Building Control Total	904,500	-245,000	659,500	
Strategic Planning of Local Plan				
Planning Strategy	312,800	0	312,800	M Russell
Preparation of Core Strategy	17,200	0	17,200	M Russell
Strategic Planning of Local Plan Total	330,000	0	330,000	
Waste & Recycling				
Street Cleansing	679,700	0	679,700	C Novoth
Recycling and Environmental Initiatives	129,500	0	129,500	C Novoth
Refuse Collection - New Scheme	1,829,600	0	1,829,600	C Novoth
Multi-Bank Recycling Sites - New Scheme	411,200	0	411,200	C Novoth
Waste & Recycling Total	3,050,000	0	3,050,000	
Environment Committee Total	6,775,200	-761,600	6,013,600	

Services by Committee	Gross Budget £	Support Service Income £	Net Budget £	Budget Holder
Strategy & Resources Committee				
Asset Management				
Facilities Management	164,900	-164,900	0	M Hammond
Asset Management	269,500	-269,500	0	A Fisk
Building Maintenance	91,700	-91,700	0	A Fisk
Head of Asset Management	99,000	-99,000	0	A Fisk
Regeneration Business Support	65,600	-65,600	0	A Fisk
Miscellaneous Properties and Land	111,200	0	111,200	A Fisk
Old Town Hall	-8,800	0	-8,800	P McLaughlin
Kingshill House	1,800	0	1,800	A Fisk
Woodchester Mansion	11,400	0	11,400	A Fisk
Cornhill Market	47,000	0	47,000	A Fisk
Shambles	-2,500	0	-2,500	A Fisk
Littlecombe site, Dursley	41,600	0	41,600	A Fisk
Brunel Mall	-28,300	0	-28,300	A Fisk
Industrial Units	35,800	0	35,800	A Fisk
Dursley Bus Station	-2,900	0	-2,900	A Fisk
Bus Shelters	3,600	0	3,600	A Fisk
Car Parks - Outside Stroud	56,000	0	56,000	A Fisk
Car Parks - Stroud Town Centre	-309,100	0	-309,100	A Fisk
Multi Storey Car Park	-46,700	0	-46,700	A Fisk
Asset Management Total	600,800	-690,700	-89,900	
Economic Development				
Economic Development	60,400	0	60,400	M Russell
Business Development	220,000	0	220,000	M Russell
Market Town Projects	27,000	0	27,000	M Russell
Regeneration	169,800	0	169,800	M Russell
Economic Development Total	477,200	0	477,200	
Resources & Finance				
Chief Executive	200,500	-200,500	0	D Hagg
Head of Corporate Resources	83,300	-83,300	0	A Sharpe
Human Resources	354,900	-354,900	0	A Sharpe
Policy and Review	169,600	-169,600	0	A Sharpe
Marketing	62,200	-62,200	0	A Sharpe
Head of Finance	117,800	-117,800	0	S Cowley
Financial Services	1,013,300	-1,013,300	0	S Cowley
Information & Communication Technology	863,400	-881,600	-18,200	S Cowley
Land & Property Custodian	32,500		32,500	S Cowley
Monitoring Officer	72,900	-72,900	0	P Woodcock
Legal Services	409,400	-409,400	0	P Woodcock
Ebley Mill	676,200	-676,200	0	M Hammond

Services by Committee	Gross Budget £	Support Service Income £	Net Budget £	Budget Holder
Past service pension costs	935,600	0	935,600	S Cowley
Unallocated maintenance budget	128,900	0	128,900	S Cowley
Unallocated budget	35,100	0	35,100	S Cowley
Democratic Representation and Management	59,700	0	59,700	A Sharpe
Members' Expenses	531,100	0	531,100	A Sharpe
Civic Fund	11,900	0	11,900	A Sharpe
Membership Subscriptions	13,600	0	13,600	S Cowley
Twinning Expenses	4,800	0	4,800	A Sharpe
Youth Councils	4,400	0	4,400	P Sullivan
Democratic Services	231,300	0	231,300	A Sharpe
Corporate Management	317,200	0	317,200	S Cowley
Council Publications	14,400	0	14,400	A Sharpe
Audit Fee	75,400	0	75,400	S Cowley
Bank Charges	20,200	0	20,200	S Cowley
Treasury Consultancy	9,600	0	9,600	S Cowley
Pension Costs	49,600	0	49,600	S Cowley
Electoral Registration	107,700	0	107,700	A Sharpe
Elections	201,600	0	201,600	A Sharpe
Emergency Management	140,700	-45,500	95,200	M Hammond
Resources & Finance Total	6,948,800	-4,087,200	2,861,600	
Strategy & Resources Committee Total	8,026,800	-4,777,900	3,248,900	
Total General Fund Budget 2013/14	21,712,700	-6,753,600	14,959,100	

Environment Committee - Outside Bodies

1. Berkeley Nuclear Stakeholders

The overarching purpose of the Site Stakeholder Group is to be the prime interface between the community, the site operator and the Nuclear Decommissioning Authority.

Contact details: Steven Payne Tel: 01453 813378

Email: steve.payne@magnoxsouthsites.com

Web: www.sitestakeholdergroups.org.uk

Postal: Berkeley Site Communications, Magnox Ltd, Berkeley Site, Berkeley, GL13 9PA.

Current Member: Councillor Liz Ashton

2. Lower Severn Drainage Board

The Lower Severn Internal Drainage Board has an administrative area covering over 26,000 hectares of land alongside the Rivers Severn, Cam, Frome, Leadon and Little Avon in the county and unitary authorities of Gloucestershire, South Gloucestershire, Herefordshire, Worcestershire and Bristol City.

Contact details: Mrs Jackie Iwaskiw

Email: admin@lowersevernldb.org.uk

Web: www.lowersevernldb.org.uk

Postal: Lower Severn Internal Drainage Board, Waterside Buildings, Oldbury Naite, Thornbury, South Glos, BS35 1RF

Current Member: Councillor John Jones

3. Minchinhampton & Rodborough Common Local Management Committee

The Committee plans the maintenance of the commons in conjunction with graziers. The Local Management Committee is now part of the National Trust. This is a 2 year term of office.

Contact details: Tina Curry

Email: tina.curry@nationaltrust.org.uk

Web:

Postal:

Current Member: Councillor Nigel Prenter

4. Oldbury Power Station

See Berkeley Power

Contact details: Steven Payne Tel: 01453 813378

Email: steve.payne@magnoxsouthsites.com

Web: www.sitestakeholdergroups.org.uk

Postal: Berkeley Site Communications, Magnox Ltd, Berkeley Site, Berkeley, GL13 9PA.

Severn Estuary Partnership

No longer an outside body organisation. The Partnership liaise with the Strategic Planning Manager.

5. Wessex Water

Wessex Water has a customer and community liaison panel. Previous representatives reported back that Wessex Water as a company was very receptive and applauded their engagement with councils, businesses and the public.

Contact details: Rebecca Saunders – 01225 526193

Email: Rebecca.saunders@wessexwater.co.uk

Web: www.wessexwater.co.uk

Postal: Wessex Water, Claverton Downs, Bath, BA2 7WW

Current Member: vacancy

6. Cotswold AONB

Covering 790 sq miles, the Cotswolds stretches from the City of Bath and Wiltshire in the south through Gloucestershire and Oxfordshire to Warwickshire and Worcestershire in the north.

Contact Details: Lorna Halling (Office Manager) Tel: 01451 862009

Email: lorna.halling@cotswoldaonb.org.uk

Website: www.cotswoldsaonb.org.uk

Postal: Cotswolds Conservation Board, Fosse Way, Northleach, Gloucestershire, GL54 3JH

Current Member: Councillor Rowland Blackwell

7. Stroud Valleys Project Board

Stroud Valleys Project's work is funded through support from local authorities (county, district, town and parish councils), charitable trusts, government agencies, national lottery and other grant-giving bodies. Originally founded in 1988 to help protect the industrial heritage of Stroud and its five valleys, SVP has established its reputation since then for its work with local community groups and volunteers: helping, inspiring and training them to discover and nurture the wildlife and green spaces on their doorsteps. In this way, it is opening up opportunities for a much wider group of people to become involved in environmental improvement, reaching out to young and old, as well as to those previously cut off from such activities by disadvantage or disability.

Contact Details: Tel: 01453 753358
Email: info@stroudvalleysproject.org
Website: www.stroudvalleysproject.org
Postal: 8 Threadneedle Street, Stroud, GL5 1AF

Current Member: Councillor Paul Denney

8. Tyndale Monument Charity

The monument consists of a tower, 26ft 6in square at the base, and 111ft. high. It is entered on the east side, and contains a staircase leading to a gallery, which is to be adorned with pieces of sculpture, illustrating the chief events in the life of Tyndale and the history of the English Reformation.

Contact Details: Mrs P E Hicks Tel:
Email:
Website:
Postal: 13 Highlands Drive, North Nibley, Dursley, GL11 6DX

Current Members: Councillor June Cordwell and Councillor Paul Smith

**Stroud District Council
Environment Committee Business Plan
2013/14**

13 June 2013

1. Introduction to Environment Committee
2. Appointments to Outside Bodies
3. Environment Committee Budgets 2013/14
4. Business Plan

8 July 2013 (Special Meeting)

1. Stroud District Local Plan 2014-2031

12 September 2013

1. Eastington Neighbourhood Designation
2. Whiteshill and Ruscombe Neighbourhood Designation
3. Budget Monitoring Report – Quarter 1
4. Carbon Management Plan
5. Business Plan

31 October 2013

1. Budget Monitoring Report Quarter 2
2. Business Plan

5 December 2013

1. Revised Budget 2013/14 and Draft Budget 2014/15
2. Business Plan

4 February 2014

1. Budget Monitoring Report Quarter 3
2. Business Plan

13 March 2014

1. Business Plan